



TPMS

Technical Service Bulletin



Repair Procedure

RP-201-014

Applies To: Mitsubishi Assisted OBD Relearn: Lancer, Mirage Outlander, and RVR

February 11, 2014

Scope of this bulletin:

Provide an overview of the OBDII Assisted Relearn for the Mitsubishi Lancer, Mirage, Outlander, and RVR, using the new Mitsubishi OBDII Adaptor with your 400 Plus, 400SD or 500.

Topics covered in this bulletin:

- 1.0 What is required: Adaptor (WRTOBD002) and R51 software update or later
- 2.0 Coverage for: Mitsubishi Lancer, Mirage, Outlander, and RVR
- 3.0 Mitsubishi OBDII Assisted Relearn process

1.0 What is required

Adaptor Kit (WRTOBD002)

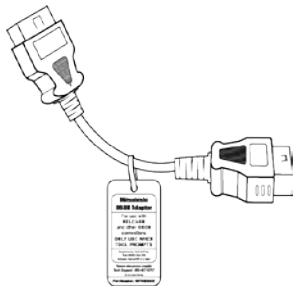

Note: DO NOT connect your tool to the vehicle OBDII port without using this ADAPTOR connected to the tool OBDII cable.

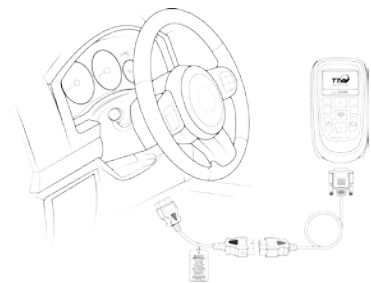

Software release 51 or later

R51.0 introduces TPMS coverage previously not available to the aftermarket. With this OBDII Assisted Relearn, a technician will be able to properly diagnose TPMS problems [including reading vehicle Diagnostic Trouble Codes] and complete the TPMS relearn.

		
Tech 400 Plus	Tech 400SD	Tech 500
Software Version R51.0 or newer	Software Version R51.0 or newer	Software Version R51.0 or newer



TPMS

Technical Service Bulletin



Repair Procedure

RP-201-014

2.0 Vehicle coverage Mitsubishi Lancer, Outlander, RVR, and Mirage

	2003	2004	2005	2006	2007	2008	2009	2010	2011	2012	2013	2014	
Eclipse				Standard OBD Relearn									
Endeavor		Standard OBD Relearn											
Galant		Standard OBD Relearn											
Lancer						Assisted Relearn							
Mirage												Assisted	
Outlander					Assisted Relearn								
Raider						Standard OBD Relearn							
RVR								Assisted Relearn					

3.0 Mitsubishi OBDII Assisted Relearn process

By following a few simple on-screen steps, a technician can service these vehicles quickly and efficiently. Tech400SD and Tech500 tools have the process driven menu flow will prompt you through these steps. When using a Tech400+ tool, you will begin with the SELECT BY VEHICLE

1. Begin by turning on your tool and under RELEARN selecting the proper MAKE MODEL and YEAR for the vehicle being serviced
2. Activate all 4 sensors beginning with the DRIVER SIDE FRONT [LF] and proceeding clockwise around, ending with the DRIVER SIDE REAR
3. Your Bartec tool will prompt you to connect the adaptor. Connect the OBDII cable to your tool and then attached the adaptor to the cable. Connect the tool to the vehicle via the OBDII port.
4. The next screen is "Select Assisted Relearn type. Use the arrow key to select the method of activation being used. Activation Options Are:
 Activation Tool – Use a second TPMS tool to activate each sensor during the relearn.
 Reduce Air Pressure – Let air out from the tire to force the sensors to activate during the relearn.
 Press ENTER ↵ to continue

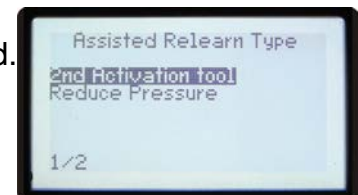
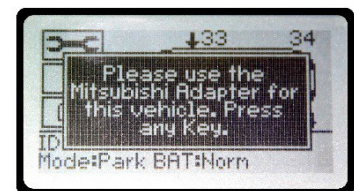
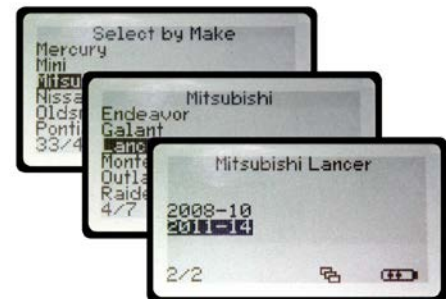



TPMS Technical Service Bulletin



Repair Procedure

RP-201-014

5. If you select "Reduce Air Pressure", the tool will then prompt you to reduce the pressure from the left front wheel. When the vehicle successfully receives the signal from the sensor, the screen will flash and prompt you onto the next wheel. Repeat for right front, right rear, and left rear wheels. Once it has all 4 sensor transmissions, the tool will say it was successful and tell you to unplug from the vehicle. The light should be off at this point.

**This method may take longer than "Tool Activation"*

Reduce Pressure

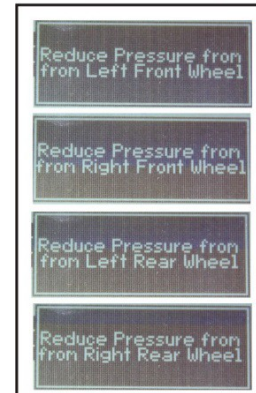

6. **PREFERRED METHOD:** If you select "Tool Activation", the tool will prompt you to use the activation tool to read the left front wheel. Once the tool reads the sensor and the vehicle receives the signal, the screen will flash and prompt you to move to the next wheel. Repeat for right front, right rear, and left rear wheels. Once it has all 4 sensor transmissions, the tool will say it was successful and tell you to unplug from the vehicle. The light should be off at this point.

With Activation Tool

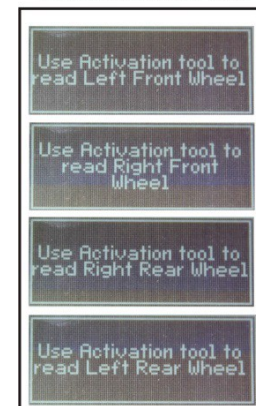

See separate service bulletins when using aftermarket replacement sensors during this Process